

GENERAL NOTES

1. THE OWNER, CONTRACTOR AND ALL SUBCONTRACTORS SHALL VERIFY ALL DIMENSIONS AND CONDITIONS AT THE SITE PRIOR TO CONSTRUCTION. THEY WILL NOTIFY THE OWNER AND FINAL DRAFT STUDIO OF ANY DISCREPANCY PRIOR TO CONSTRUCTION.
2. ALL WORKMANSHIP AND BUILDING MATERIALS SHALL CONFORM TO THE CURRENT LOCAL AND INTERNATIONAL BUILDING CODES THAT APPLY.
3. ALL PLUMBING, MECHANICAL, AND ELECTRICAL WORK MUST BE DONE BY LICENSED AND INSURED CONTRACTORS. THEY OWNER MAY PERFORM WORK ON THE PROJECT IF ALLOWED BY LOCAL BUILDING DEPARTMENT.
4. ALL EXTERIOR HOUSE WALLS ARE 2X6 - 9' TALL WALLS THAT ARE TYPICAL (TYP) WALL CONSTRUCTION, ALL INTERIOR WALLS ARE 2X4 AND 2X6 WALL CONSTRUCTION. GARAGE WALL HEIGHTS MAY VARY DEPENDING ON FINAL GARAGE FOUNDATION HEIGHT AFTER FINAL GRADE IS DETERMINED.
5. ALL WINDOWS SIZES AND LOCATIONS SHOW MAY NOT BE FINAL. ALL CONTRACTORS SHALL USE THE WINDOW MANUFACTURE ROUGH OPENINGS CUT SHEET WHEN CONSTRUCTING HOUSE WALLS.

FIRST FLOOR NOTES

1. FIRST FLOOR AREA = 2940 SQFT, EXCLUDING COVERED PORCHES
2. THREE GARAGE AREA = ---- SQFT

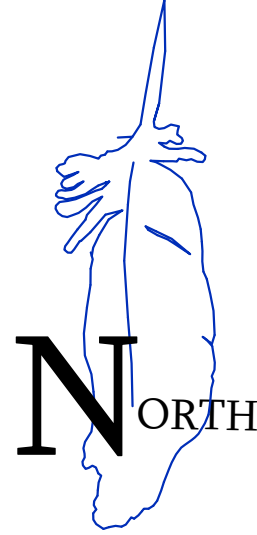
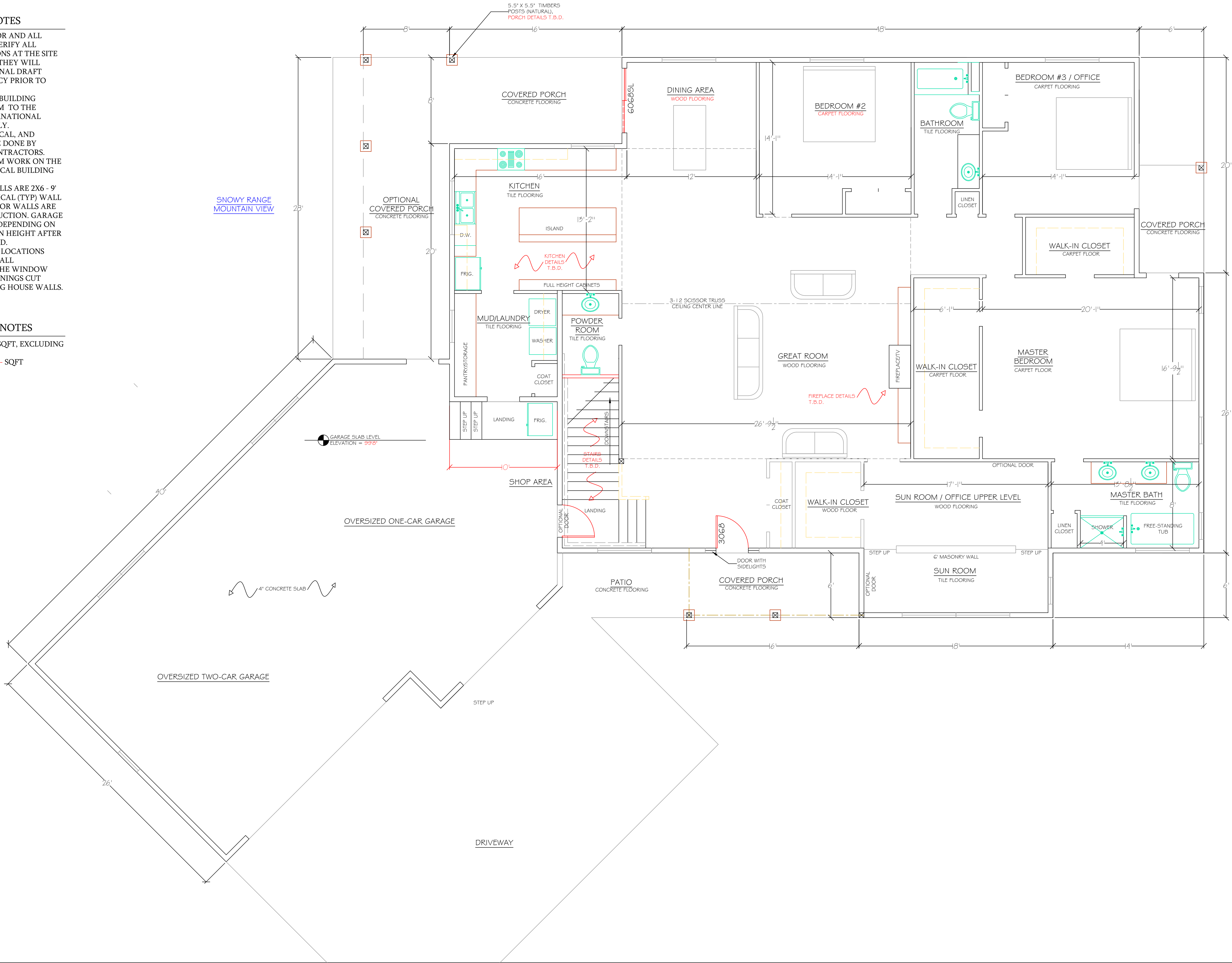

finaldraftstudio.com

Copyright 2020:  
Final Draft Studio  
All Rights Reserved

**FINAL DRAFT STUDIO**  
Email: seth@finaldraftstudio.com

Phone: 307-760-5998

Mailing Address:  
PO Box 415  
Laramie, WY 82073

Page - Bennett Residence Project 2020  
Prepared for Darroll Bennett and Anne Page

Date:	12/12/2019	Drawn By:	Seth Carson
Revised:	1/14/2020	Drawn By:	Seth Carson
Revised:		Drawn By:	Seth Carson
Revised:		Drawn By:	Seth Carson
Bid Set:		Drawn By:	Seth Carson
Final Ver:		Drawn By:	Seth Carson

A.200  
FIRST FLOOR  
PLAN -  
REV-1A